

OFFICES TO LET

FLEXIBLE LEASE TERMS | ALL-INCLUSIVE RENTS



MAPLE COURT

GROVE PARK BUSINESS ESTATE, WHITE WALTHAM
MAIDENHEAD SL6 3LW

ESTABLISHED BUSINESS PARK LOCATION
ON-SITE AMENITY
AMPLE ALLOCATED PARKING

193 sq ft to 220 sq ft
(18 sq m to 20 sq m)

LOCATION

Grove Park Business Estate is located in the village of White Waltham, 3.5 miles west of Maidenhead town centre.

Grove Park Business Estate benefits from good access via the A404(M) linking to both the M4 (J8/9) and M40 (J4) motorways, providing easy access to Heathrow Airport, Central London and the national motorway network via the M25.

Closest rail station is in Maidenhead (3.5 miles) which provides a direct service to London Paddington in 19 minutes.

ACCOMMODATION

| 1st floor | Size | All Inclusive Rent (pa) |
|-----------|-----------|-------------------------|
| Suite 10 | 220 sq ft | £5,500 + VAT |
| Suite 15 | 193 sq ft | £5,500 + VAT |

AMENITIES

- Highly secure location
- Dongle & Fibre Broadband options available on request
- High quality landscaped environment
- On-site amenity (including café and children's nursery)
- Communal kitchen facilities
- Male, female and disabled WCs
- On-site car parking

EPC

EPC rating TBC

TERMS

A new lease will be granted directly by the landlord for a term to be agreed.

VIEWINGS

Strictly by appointment through Joint Agents.

For further information or to arrange a viewing contact:

Kempton Carr Croft

David Pearce, david.pearce@kemptoncarr.co.uk or 01628 771221
Mitchell Brooks, mitchell.brooks@kemptoncarr.co.uk or 01628 771221

Page Hardy Harris



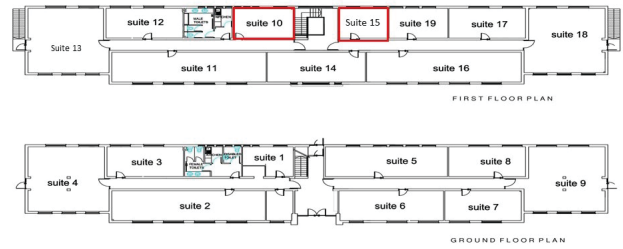

Mark Harris, mark@pagehardyharris.co.uk or 01628 439006
Kieran Webber, kieran@pagehardyharris.co.uk or 01628 439006

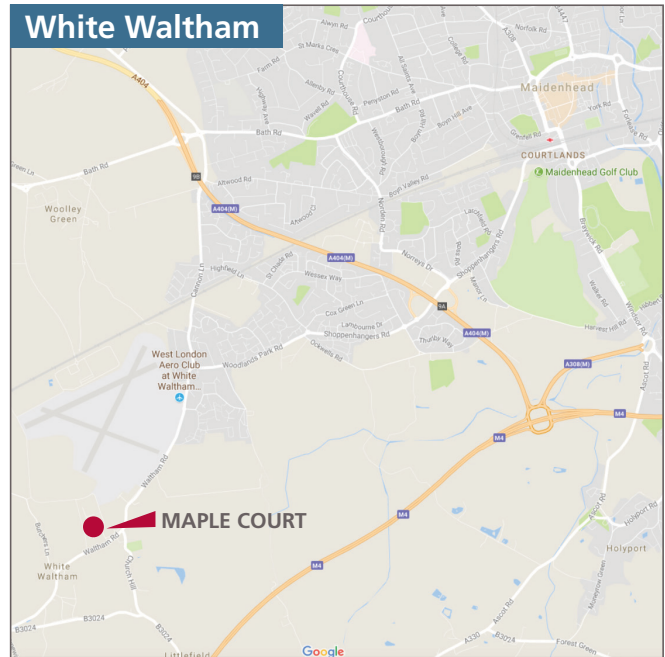

Not to scale



TRANSPORT LINKS

| | | |
|---|--------------------|------------|
|  | Maidenhead Station | 3.6 miles |
|  | M4 (Junction 8/9) | 3.8 miles |
|  | M40 (Junction 4) | 9.8 miles |
|  | Heathrow Airport | 17.9 miles |

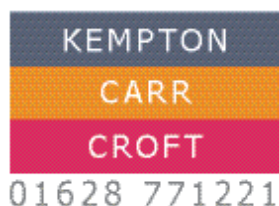

Property owned and managed by:

